



Cylinder Connections

CGA DISS / CGA / DIN / JIS



CONTENTS

CGA DISS SERIES

NIPPLES - 10 Series

316L Stainless Steel.
Non-rotating design.
Heat code traceability.



NUTS - 20 Series

303 Stainless Steel Silver Plated.

GASKETS - 30 Series

Nickel 200/PCTFE/Aluminum.
Retainer ring included.

INLET CONNECTIONS - 40 Series

Nipple, Nut and Gasket included.

OUTLET BLANK PLUGS - 50 Series

316L Stainless Steel.
Non-rotating design.

OUTLET ADAPTERS - 70 Series

316L Stainless Steel.
Non-rotating design.

CYLINDER VALVE OUTLET CAPS - 90 Series

316L Stainless Steel.
Chain, Ring and Gasket included.
Gas tight design.

COMPLETE PIGTAIL CONNECTIONS - 100 Series

Nipple, Nut, Gasket and Blank Plug included.

CGA & DIN / JIS SERIES

NIPPLES - 10 Series

316L Stainless Steel.

NUTS - 20 Series

303 Stainless Steel.



WASHERS - 30 Series

Washers available in PCTFE and PTFE.

INLET CONNECTIONS - 40 Series

Nipple, Nut and Washer included.

OUTLET BLANK PLUGS - 50 Series

316L Stainless Steel.

OUTLET BLANK CAPS - 60 Series

316L Stainless Steel.

OUTLET ADAPTERS - 70 Series

316L Stainless Steel.

CYLINDER VALVE OUTLET PLUGS - 80 Series

303 Stainless Steel.
Chain and Ring included.

CYLINDER VALVE OUTLET CAPS - 90 Series

303 Stainless Steel.
Chain, Ring and Polyethylene disc included.

COMPLETE PIGTAIL CONNECTIONS - 100 Series

Nipple, Nut, Washer and Blank Plug or Cap included.

GAS CONNECTION ASSIGNMENT TABLE

TBW AND METAL FACE SEAL FITTINGS

components are ordered by product code as listed in this catalogue

ORDERING INFORMATION

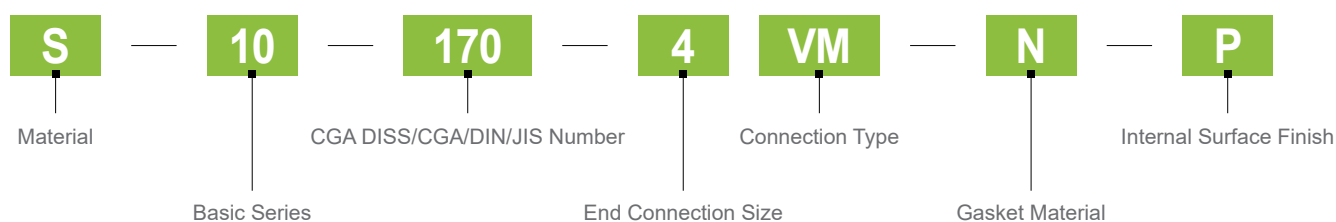

Material	Basic Series	CGA DISS/CGA/DIN/JIS Number
S = 316L Stainless Steel	10 = Nipples	Reference Gas Connection Assignment Table
D = 316L Stainless Steel VAR	20 = Nuts	
3S = 303 Stainless Steel	30 = Gaskets & Washers	
SS = 303 Stainless Steel Silver Plated	40 = Inlet Connection *Nipple, Nut and Gasket *Nipple, Nut and Washer	
N = Nickel 200	50 = Outlet Blank Plugs	
PC = PCTFE	60 = Outlet Blank Caps	
T = PTFE	70 = Outlet Adapters	
AL = Aluminum	80 = Cylinder Valve Outlet Plugs *Chain and Ring included	
	90 = Cylinder Valve Outlet Caps *Chain, Ring and Gasket included *Chain, Ring and Polyethylene disc included	
	100 = Complete Pigtail Connections *Nipple, Nut, Gasket and Blank Plug *Nipple, Nut, Washer and Blank Plug or Cap	

End Connection Size	Connection Type	Gasket Material	Internal Surface Finish
2 = 1/8"	TW = Auto Tube Weld	N = Nickel 200	BLANK = 3.0µm
4 = 1/4"	VM = MFS Male	PC = PCTFE	P = 0.7µm
	NM = NPT Male	T = PTFE	
	NF = NPT Female	AL = Aluminum	
		PD = Polyethylene disc	



CGA DISS Series

NIPPLES - 10 Series

NUTS - 20 Series

GASKETS - 30 Series

INLET CONNECTIONS - 40 Series

OUTLET BLANK PLUGS - 50 Series

OUTLET ADAPTERS - 70 Series

CYLINDER VALVE OUTLET CAPS - 90 Series

COMPLETE PIGTAIL CONNECTIONS - 100 Series



CGA DISS SERIES

INLET CONNECTIONS (NIPPLE, NUT AND GASKET INCLUDED)

AUTO TUBE WELD

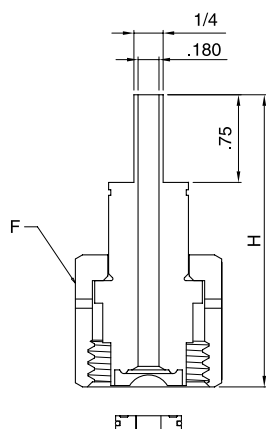

FACESEAL MALE

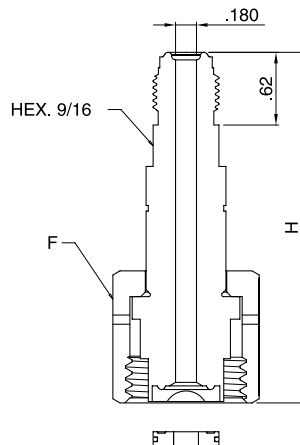

NPT MALE

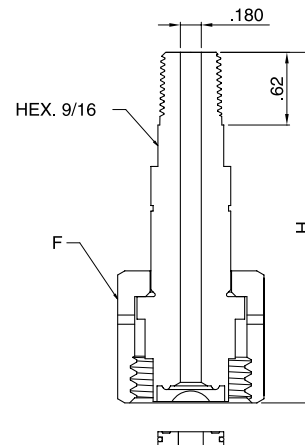

CGA DISS Number	End Connection	Assembly Part Number	H Overall Length		Nipple Part Number	Nut Part Number	F Hex Flat	Gasket Part Number (Nickel)	Gasket Part Number (PCTFE)	Gasket Part Number
			in	mm						
632	1/4" Auto Tube Weld	□-40-632-4TW-□□	2.50	63.5	□-10-632-4TW-□	SS-20-630	1-1/4	N-30-630	PC-30-630	AL-30-630
	1/4" Face Seal Male	□-40-632-4VM-□□	3.00	76.2	□-10-632-4VM-□					
	1/4" NPT Male	□-40-632-4NM-□□	3.00	76.2	□-10-632-4NM-□					
634	1/4" Auto Tube Weld	□-40-634-4TW-□□	2.50	63.5	□-10-634-4TW-□	SS-20-630	1-1/4	N-30-630	PC-30-630	AL-30-630
	1/4" Face Seal Male	□-40-634-4VM-□□	3.00	76.2	□-10-634-4VM-□					
	1/4" NPT Male	□-40-634-4NM-□□	3.00	76.2	□-10-634-4NM-□					
636	1/4" Auto Tube Weld	□-40-636-4TW-□□	2.50	63.5	□-10-636-4TW-□	SS-20-630	1-1/4	N-30-630	PC-30-630	AL-30-630
	1/4" Face Seal Male	□-40-636-4VM-□□	3.00	76.2	□-10-636-4VM-□					
	1/4" NPT Male	□-40-636-4NM-□□	3.00	76.2	□-10-636-4NM-□					
638	1/4" Auto Tube Weld	□-40-638-4TW-□□	2.50	63.5	□-10-638-4TW-□	SS-20-630	1-1/4	N-30-630	PC-30-630	AL-30-630
	1/4" Face Seal Male	□-40-638-4VM-□□	3.00	76.2	□-10-638-4VM-□					
	1/4" NPT Male	□-40-638-4NM-□□	3.00	76.2	□-10-638-4NM-□					
640	1/4" Auto Tube Weld	□-40-640-4TW-□□	2.50	63.5	□-10-640-4TW-□	SS-20-630	1-1/4	N-30-630	PC-30-630	AL-30-630
	1/4" Face Seal Male	□-40-640-4VM-□□	3.00	76.2	□-10-640-4VM-□					
	1/4" NPT Male	□-40-640-4NM-□□	3.00	76.2	□-10-640-4NM-□					
642	1/4" Auto Tube Weld	□-40-642-4TW-□□	2.50	63.5	□-10-642-4TW-□	SS-20-630	1-1/4	N-30-630	PC-30-630	AL-30-630
	1/4" Face Seal Male	□-40-642-4VM-□□	3.00	76.2	□-10-642-4VM-□					
	1/4" NPT Male	□-40-642-4NM-□□	3.00	76.2	□-10-642-4NM-□					
712	1/4" Auto Tube Weld	□-40-712-4TW-□□	2.50	63.5	□-10-712-4TW-□	SS-20-710	1-3/8	N-30-630	PC-30-630	AL-30-630
	1/4" Face Seal Male	□-40-712-4VM-□□	3.00	76.2	□-10-712-4VM-□					
	1/4" NPT Male	□-40-712-4NM-□□	3.00	76.2	□-10-712-4NM-□					
714	1/4" Auto Tube Weld	□-40-714-4TW-□□	2.50	63.5	□-10-714-4TW-□	SS-20-710	1-3/8	N-30-630	PC-30-630	AL-30-630
	1/4" Face Seal Male	□-40-714-4VM-□□	3.00	76.2	□-10-714-4VM-□					
	1/4" NPT Male	□-40-714-4NM-□□	3.00	76.2	□-10-714-4NM-□					
716	1/4" Auto Tube Weld	□-40-716-4TW-□□	2.50	63.5	□-10-716-4TW-□	SS-20-710	1-3/8	N-30-630	PC-30-630	AL-30-630
	1/4" Face Seal Male	□-40-716-4VM-□□	3.00	76.2	□-10-716-4VM-□					
	1/4" NPT Male	□-40-716-4NM-□□	3.00	76.2	□-10-716-4NM-□					

CGA DISS SERIES

INLET CONNECTIONS (NIPPLE, NUT AND GASKET INCLUDED) CONTINUED FROM PREVIOUS PAGE

CGA DISS Number	End Connection	Assembly Part Number	H Overall Length		Nipple Part Number	Nut Part Number	F Hex Flat	Gasket Part Number (Nickel)	Gasket Part Number (PCTFE)	Gasket Part Number (Aluminum)
			in	mm						
718	1/4" Auto Tube Weld	□-40-718-4TW-□-□	2.50	63.5	□-10-718-4TW-□	SS-20-710	1-3/8	N-30-630	PC-30-630	AL-30-630
	1/4" Faceseal Male	□-40-718-4VM-□-□	3.00	76.2	□-10-718-4VM-□					
	1/4" NPT Male	□-40-718-4NM-□-□	3.00	76.2	□-10-718-4NM-□					
720	1/4" Auto Tube Weld	□-40-720-4TW-□-□	2.50	63.5	□-10-720-4TW-□	SS-20-710	1-3/8	N-30-630	PC-30-630	AL-30-630
	1/4" Faceseal Male	□-40-720-4VM-□-□	3.00	76.2	□-10-720-4VM-□					
	1/4" NPT Male	□-40-720-4NM-□-□	3.00	76.2	□-10-720-4NM-□					
722	1/4" Auto Tube Weld	□-40-722-4TW-□-□	2.50	63.5	□-10-722-4TW-□	SS-20-710	1-3/8	N-30-630	PC-30-630	AL-30-630
	1/4" Faceseal Male	□-40-722-4VM-□-□	3.00	76.2	□-10-722-4VM-□					
	1/4" NPT Male	□-40-722-4NM-□-□	3.00	76.2	□-10-722-4NM-□					
724	1/4" Auto Tube Weld	□-40-724-4TW-□-□	2.50	63.5	□-10-724-4TW-□	SS-20-710	1-3/8	N-30-630	PC-30-630	AL-30-630
	1/4" Faceseal Male	□-40-724-4VM-□-□	3.00	76.2	□-10-724-4VM-□					
	1/4" NPT Male	□-40-724-4NM-□-□	3.00	76.2	□-10-724-4NM-□					
726	1/4" Auto Tube Weld	□-40-726-4TW-□-□	2.50	63.5	□-10-726-4TW-□	SS-20-710	1-3/8	N-30-630	PC-30-630	AL-30-630
	1/4" Faceseal Male	□-40-726-4VM-□-□	3.00	76.2	□-10-726-4VM-□					
	1/4" NPT Male	□-40-726-4NM-□-□	3.00	76.2	□-10-726-4NM-□					
728	1/4" Auto Tube Weld	□-40-728-4TW-□-□	2.50	63.5	□-10-728-4TW-□	SS-20-710	1-3/8	N-30-630	PC-30-630	AL-30-630
	1/4" Faceseal Male	□-40-728-4VM-□-□	3.00	76.2	□-10-728-4VM-□					
	1/4" NPT Male	□-40-728-4NM-□-□	3.00	76.2	□-10-728-4NM-□					

GASKETS (CGA DISS 632~728)

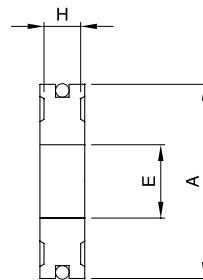

Gasket Part Number	Material	A		E		H	
		in	mm	in	mm	in	mm
N-30-630	Nickel 200	.563	14.3	.213	5.4	.105	2.7
PC-30-630	PCTFE	.563	14.3	.213	5.4	.125	3.2
AL-30-630	Aluminum	.563	14.3	.213	5.4	.105	2.7

CGA DISS SERIES

OUTLET ADAPTERS AND BLANK PLUGS

BLANK PLUG

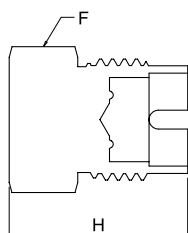

FACESEAL MALE

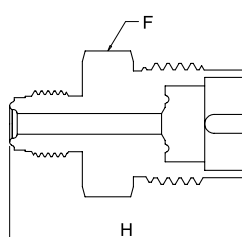

NPT FEMALE

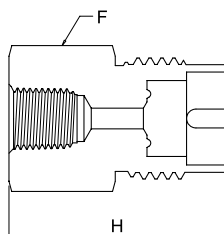

CGA DISS Number	End Connection	Part Number	H Overall Length		F Hex Flat
			in	mm	
632	Blank Plug 1/4" Face seal Male 1/4" NPT Female	□-50-632-□	1.53	38.9	1-1/8
		□-70-632-4VM-□	2.00	50.8	
		□-70-632-4NF-□	1.85	47.0	
634	Blank Plug 1/4" Face seal Male 1/4" NPT Female	□-50-632-□	1.53	38.9	1-1/8
		□-70-634-4VM-□	2.00	50.8	
		□-70-634-4NF-□	1.85	47.0	
636	Blank Plug 1/4" Face seal Male 1/4" NPT Female	□-50-632-□	1.53	38.9	1-1/8
		□-70-636-4VM-□	2.00	50.8	
		□-70-636-4NF-□	1.85	47.0	
638	Blank Plug 1/4" Face seal Male 1/4" NPT Female	□-50-632-□	1.53	38.9	1-1/8
		□-70-638-4VM-□	2.00	50.8	
		□-70-638-4NF-□	1.85	47.0	
640	Blank Plug 1/4" Face seal Male 1/4" NPT Female	□-50-632-□	1.53	38.9	1-1/8
		□-70-640-4VM-□	2.00	50.8	
		□-70-640-4NF-□	1.85	47.0	
642	Blank Plug 1/4" Face seal Male 1/4" NPT Female	□-50-632-□	1.53	38.9	1-1/8
		□-70-642-4VM-□	2.00	50.8	
		□-70-642-4NF-□	1.85	47.0	
712	Blank Plug 1/4" Face seal Male 1/4" NPT Female	□-50-712-□	1.53	38.9	1-1/4
		□-70-712-4VM-□	2.00	50.8	
		□-70-712-4NF-□	1.85	47.0	
714	Blank Plug 1/4" Face seal Male 1/4" NPT Female	□-50-712-□	1.53	38.9	1-1/4
		□-70-714-4VM-□	2.00	50.8	
		□-70-714-4NF-□	1.85	47.0	
716	Blank Plug 1/4" Face seal Male 1/4" NPT Female	□-50-712-□	1.53	38.9	1-1/4
		□-70-716-4VM-□	2.00	50.8	
		□-70-716-4NF-□	1.85	47.0	
718	Blank Plug 1/4" Face seal Male 1/4" NPT Female	□-50-712-□	1.53	38.9	1-1/4
		□-70-718-4VM-□	2.00	50.8	
		□-70-718-4NF-□	1.85	47.0	
720	Blank Plug 1/4" Face seal Male 1/4" NPT Female	□-50-720-□	1.53	38.9	1-1/4
		□-70-720-4VM-□	2.00	50.8	
		□-70-720-4NF-□	1.85	47.0	
722	Blank Plug 1/4" Face seal Male 1/4" NPT Female	□-50-720-□	1.53	38.9	1-1/4
		□-70-722-4VM-□	2.00	50.8	
		□-70-722-4NF-□	1.85	47.0	
724	Blank Plug 1/4" Face seal Male 1/4" NPT Female	□-50-720-□	1.53	38.9	1-1/4
		□-70-724-4VM-□	2.00	50.8	
		□-70-724-4NF-□	1.85	47.0	
726	Blank Plug 1/4" Face seal Male 1/4" NPT Female	□-50-720-□	1.53	38.9	1-1/4
		□-70-726-4VM-□	2.00	50.8	
		□-70-726-4NF-□	1.85	47.0	
728	Blank Plug 1/4" Face seal Male 1/4" NPT Female	□-50-720-□	1.53	38.9	1-1/4
		□-70-728-4VM-□	2.00	50.8	
		□-70-728-4NF-□	1.85	47.0	

CGA DISS SERIES

CYLINDER VALVE OUTLET CAPS (CHAIN, RING AND GASKET INCLUDED)

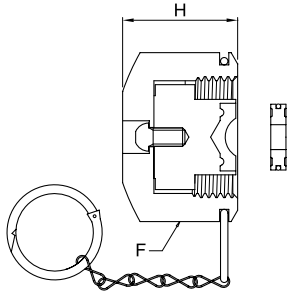

CGA DISS Number	Assembly Part Number	H Overall Length		F Hex Flat	Gasket Part Number (Nickel)	Gasket Part Number (PTFE)	Gasket Part Number (Aluminum)
		in	mm				
632	□-90-630-□-□	.98	24.9	1-1/4	N-30-630	PC-30-630	AL-30-630
634	□-90-630-□-□	.98	24.9	1-1/4	N-30-630	PC-30-630	AL-30-630
636	□-90-630-□-□	.98	24.9	1-1/4	N-30-630	PC-30-630	AL-30-630
638	□-90-630-□-□	.98	24.9	1-1/4	N-30-630	PC-30-630	AL-30-630
640	□-90-630-□-□	.98	24.9	1-1/4	N-30-630	PC-30-630	AL-30-630
642	□-90-630-□-□	.98	24.9	1-1/4	N-30-630	PC-30-630	AL-30-630
712	□-90-710-□-□	.98	24.9	1-3/8	N-30-630	PC-30-630	AL-30-630
714	□-90-710-□-□	.98	24.9	1-3/8	N-30-630	PC-30-630	AL-30-630
716	□-90-710-□-□	.98	24.9	1-3/8	N-30-630	PC-30-630	AL-30-630
718	□-90-710-□-□	.98	24.9	1-3/8	N-30-630	PC-30-630	AL-30-630
720	□-90-710-□-□	.98	24.9	1-3/8	N-30-630	PC-30-630	AL-30-630
722	□-90-710-□-□	.98	24.9	1-3/8	N-30-630	PC-30-630	AL-30-630
724	□-90-710-□-□	.98	24.9	1-3/8	N-30-630	PC-30-630	AL-30-630
726	□-90-710-□-□	.98	24.9	1-3/8	N-30-630	PC-30-630	AL-30-630
728	□-90-710-□-□	.98	24.9	1-3/8	N-30-630	PC-30-630	AL-30-630

COMPLETE PIGTAIL CONNECTIONS (NIPPLE, NUT, GASKET AND BLANK PLUG INCLUDED)

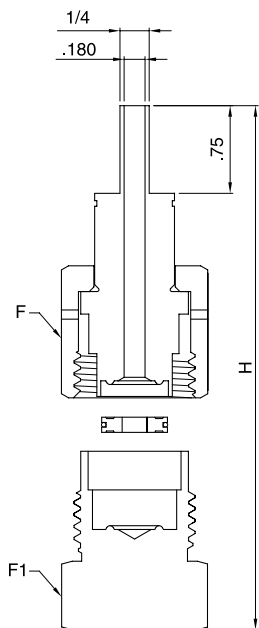

CGA DISS Number	Assembly Part Number	H Overall Length		F Hex Flat	F ₁ Hex Flat	Gasket Part Number (Nickel)	Gasket Part Number (PTFE)	Gasket Part Number
		in	mm					
632	□-100-632-4TW-□-□	3.4	86.4	1-1/4	1-1/8	N-30-630	PC-30-630	AL-30-630
634	□-100-634-4TW-□-□	3.4	86.4	1-1/4	1-1/8	N-30-630	PC-30-630	AL-30-630
636	□-100-636-4TW-□-□	3.4	86.4	1-1/4	1-1/8	N-30-630	PC-30-630	AL-30-630
638	□-100-638-4TW-□-□	3.4	86.4	1-1/4	1-1/8	N-30-630	PC-30-630	AL-30-630
640	□-100-640-4TW-□-□	3.4	86.4	1-1/4	1-1/8	N-30-630	PC-30-630	AL-30-630
642	□-100-642-4TW-□-□	3.4	86.4	1-1/4	1-1/8	N-30-630	PC-30-630	AL-30-630
712	□-100-712-4TW-□-□	3.4	86.4	1-3/8	1-1/4	N-30-630	PC-30-630	AL-30-630
714	□-100-714-4TW-□-□	3.4	86.4	1-3/8	1-1/4	N-30-630	PC-30-630	AL-30-630
716	□-100-716-4TW-□-□	3.4	86.4	1-3/8	1-1/4	N-30-630	PC-30-630	AL-30-630
718	□-100-718-4TW-□-□	3.4	86.4	1-3/8	1-1/4	N-30-630	PC-30-630	AL-30-630
720	□-100-720-4TW-□-□	3.4	86.4	1-3/8	1-1/4	N-30-630	PC-30-630	AL-30-630
722	□-100-722-4TW-□-□	3.4	86.4	1-3/8	1-1/4	N-30-630	PC-30-630	AL-30-630
724	□-100-724-4TW-□-□	3.4	86.4	1-3/8	1-1/4	N-30-630	PC-30-630	AL-30-630
726	□-100-726-4TW-□-□	3.4	86.4	1-3/8	1-1/4	N-30-630	PC-30-630	AL-30-630
728	□-100-728-4TW-□-□	3.4	86.4	1-3/8	1-1/4	N-30-630	PC-30-630	AL-30-630

CGA & DIN/JIS Series

CGA SERIES

NIPPLES - 10 Series

NUTS - 20 Series

WASHERS - 30 Series

INLET CONNECTIONS - 40 Series

OUTLET BLANK PLUGS - 50 Series

OUTLET BLANK CAPS - 60 Series

OUTLET ADAPTERS - 70 Series

CYLINDER VALVE OUTLET PLUGS - 80 Series

CYLINDER VALVE OUTLET CAPS - 90 Series

COMPLETE PIGTAIL CONNECTIONS - 100 Series

DIN / JIS SERIES

COMPLETE PIGTAIL CONNECTIONS - 100 Series



CGA SERIES

INLET CONNECTIONS (NIPPLE, NUT AND WASHER INCLUDED)

AUTO TUBE WELD

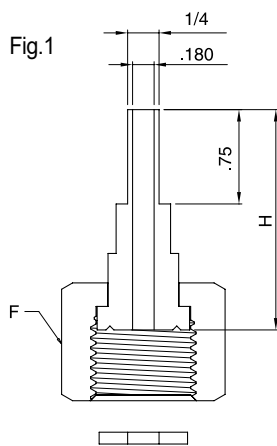

FACESEAL MALE

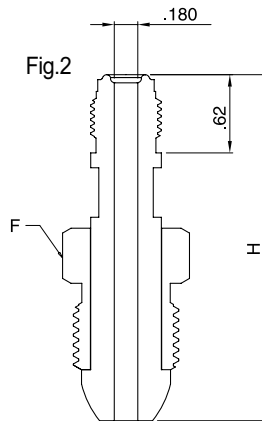

NPT MALE

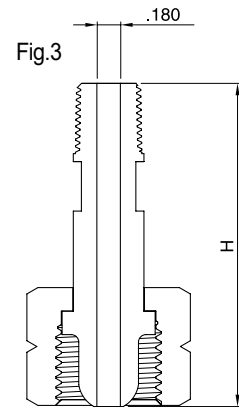

CGA DISS Number	Ref. DWG Inlet Connection	End Connection	Assembly Part Number	H Overall Length	Nipple Part Number	Nut Part Number	F Hex Flat	Washer Part Number (PCTFE)	Washer Part Number (PTFE)
170	Fig. 1	1/4" Auto Tube Weld 1/8" NPT Male	□40-170-4TW-T-□ □40-170-2NM-T-□	1-1/4 1-1/4	□10-170-4TW-□ □10-170-2NM-□	3S-20-170	3S-20-170	-	T-30-170
180	Fig. 1	1/4" Auto Tube Weld 1/8" NPT Male	□40-180-4TW-T-□ □40-180-2NM-T-□	1-1/4 1-3/4	□10-180-4TW-□ □10-180-2NM-□	3S-20-180	3S-20-180	-	T-30-180
290	Fig. 3	1/4" Auto Tube Weld 1/4" NPT Male	□40-290-4TW-□ □40-290-4NM-□	2-5/8 2-1/4	□10-290-4TW-□ □10-290-4NM-□	3S-20-290	3S-20-290	-	-
296	Fig. 2	1/4" Auto Tube Weld 1/4" Face Seal Male 1/4" NPT Male	□40-296-4TW-□ □40-296-4VM-□ □40-296-4NM-□	2-5/8 2-3/4 3-1/2	□10-296-4TW-□ □10-296-4VM-□ □10-296-4NM-□	3S-20-296	3S-20-296	-	-
320	Fig. 1	1/4" Auto Tube Weld 1/4" Face Seal Male 1/4" NPT Male	□40-320-4TW-□-□ □40-320-4VM-□-□ □40-320-4NM-□-□	1-3/4 2-3/4 3-1/2	□10-320-4TW-□ □10-320-4VM-□ □10-320-4NM-□	3S-20-320	3S-20-320	PC-30-320	T-30-320
326	Fig. 3	1/4" Auto Tube Weld 1/4" Face Seal Male 1/4" NPT Male	□40-326-4TW-□ □40-326-4VM-□ □40-326-4NM-□	2-1/4 2-1/4 3	□10-326-4TW-□ □10-326-4VM-□ □10-326-4NM-□	3S-20-326	3S-20-326	-	-
330	Fig. 1	1/4" Auto Tube Weld 1/4" Face Seal Male 1/4" NPT Male	□40-330-4TW-□-□ □40-330-4VM-□-□ □40-330-4NM-□-□	1-3/4 1-3/4 2-1/2	□10-330-4TW-□ □10-330-4VM-□ □10-330-4NM-□	3S-20-330	3S-20-330	PC-30-330	T-30-330
346	Fig. 3	1/4" Auto Tube Weld 1/4" Face Seal Male 1/4" NPT Male	□40-346-4TW-□ □40-346-4VM-□ □40-346-4NM-□	2-5/16 2-1/4 3	□10-346-4TW-□ □10-346-4VM-□ □10-346-4NM-□	3S-20-346	3S-20-346	-	-
350	Fig. 3	1/4" Auto Tube Weld 1/4" Face Seal Male 1/4" NPT Male	□40-350-4TW-□ □40-350-4VM-□ □40-350-4NM-□	2-5/16 2-1/4 3	□10-350-4TW-□ □10-350-4VM-□ □10-350-4NM-□	3S-20-350	3S-20-350	-	-

CGA SERIES

INLET CONNECTIONS (NIPPLE, NUT AND WASHER INCLUDED) CONTINUED FROM PREVIOUS PAGE

CGA DISS Number	Ref. DWG Inlet Connection	End Connection	Assembly Part Number	H Overall Length	Nipple Part Number	Nut Part Number	F Hex Flat	Washer Part Number (PCTFE)	Washer Part Number (PTFE)
510	Fig. 2	1/4" Auto Tube Weld 1/4" Faceseal Male 1/4" NPT Male	□-40-510-4TW-□ □-40-510-4VM-□ □-40-510-4NM-□	2-5/8 2-3/4 3-1/2	□-10-510-4TW-□ □-10-510-4VM-□ □-10-510-4NM-□	3S-20-510	1-1/8	-	-
540	Fig. 3	1/4" Auto Tube Weld 1/4" Faceseal Male 1/4" NPT Male	□-40-540-4TW-□ □-40-540-4VM-□ □-40-540-4NM-□	2-1/4 2-1/4 3	□-10-540-4TW-□ □-10-540-4VM-□ □-10-540-4NM-□	3S-20-540	1-1/8	-	-
580	Fig. 2	1/4" Auto Tube Weld 1/4" Faceseal Male 1/4" NPT Male	□-40-580-4TW-□ □-40-580-4VM-□ □-40-580-4NM-□	2-5/8 2-3/4 3-1/2	□-10-580-4TW-□ □-10-580-4VM-□ □-10-580-4NM-□	3S-20-580	1-1/8	-	-
590	Fig. 2	1/4" Auto Tube Weld 1/4" Faceseal Male 1/4" NPT Male	□-40-590-4TW-□ □-40-590-4VM-□ □-40-590-4NM-□	2-1/2 2-3/4 3-1/2	□-10-590-4TW-□ □-10-590-4VM-□ □-10-590-4NM-□	3S-20-590	1-1/8	-	-
660	Fig. 1	1/4" Auto Tube Weld 1/4" Faceseal Male 1/4" NPT Male	□-40-660-4TW-□-□ □-40-660-4VM-□-□ □-40-660-4NM-□-□	2-3/16 1-7/8 2-1/2	□-10-660-4TW-□ □-10-660-4VM-□ □-10-660-4NM-□	3S-20-660	1-1/4	PC-30-660	T-30-660
670	Fig. 1	1/4" Auto Tube Weld 1/4" Faceseal Male 1/4" NPT Male	□-40-670-4TW-□-□ □-40-670-4VM-□-□ □-40-670-4NM-□-□	2-3/16 1-7/8 2-1/2	□-10-670-4TW-□ □-10-670-4VM-□ □-10-670-4NM-□	3S-20-670	1-1/4	PC-30-670	T-30-670
678	Fig. 1	1/4" Auto Tube Weld 1/4" Faceseal Male 1/4" NPT Male	□-40-678-4TW-□-□ □-40-678-4VM-□-□ □-40-678-4NM-□-□	2-1/2 2 2-1/2	□-10-678-4TW-□ □-10-678-4VM-□ □-10-678-4NM-□	3S-20-678	1-1/4	PC-30-678	T-30-678
679	Fig. 1	1/4" Auto Tube Weld 1/4" Faceseal Male 1/4" NPT Male	□-40-679-4TW-□-□ □-40-679-4VM-□-□ □-40-679-4NM-□-□	2-1/2 2 3	□-10-679-4TW-□ □-10-679-4VM-□ □-10-679-4NM-□	3S-20-679	1-1/4	PC-30-679	T-30-679

CGA SERIES

OUTLET ADAPTERS AND BLANK PLUGS OR CAPS

BLANK PLUG

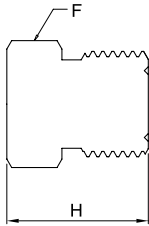

BLANK CAP

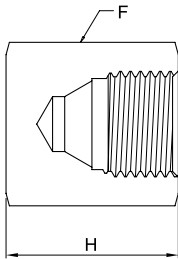

FACESEAL MALE

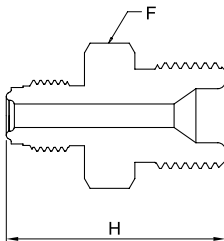

NPT FEMALE

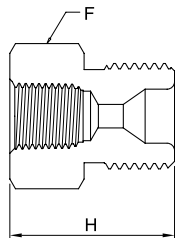

CGA DISS Number	End Connection	Part Number	H Overall Length		F Hex Flat
			in	mm	
296	Blank Cap	□-60-296-□	1.37	34.8	1-1/8
	1/4" Face Seal Male	□-70-296-4VM-□	2.00	50.8	
	1/4" NPT Female	□-70-296-4NF-□	2.00	50.8	
320	Blank Plug	□-50-320-□	1.12	28.4	1
	1/4" Face Seal Male	□-70-320-4VM-□	1.74	44.2	
	1/4" NPT Female	□-70-320-4NF-□	1.12	28.4	
326	Blank Plug	□-50-326-□	1.12	28.4	1
	1/4" Face Seal Male	□-70-326-4VM-□	1.74	44.2	
	1/4" NPT Female	□-70-326-4NF-□	1.31	33.3	
330	Blank Plug	□-50-330-□	1.12	28.4	1
	1/4" Face Seal Male	□-70-330-4VM-□	1.74	44.2	
	1/4" NPT Female	□-70-330-4NF-□	1.31	33.3	
346	Blank Plug	□-50-346-□	1.12	28.4	1
	1/4" Face Seal Male	□-70-346-4VM-□	1.88	47.8	
	1/4" NPT Female	□-70-346-4NF-□	1.31	33.3	
350	Blank Plug	□-50-350-□	1.12	28.4	1
	1/4" Face Seal Male	□-70-350-4VM-□	1.88	47.8	
	1/4" NPT Female	□-70-350-4NF-□	1.31	33.3	
510	Blank Cap	□-60-510-□	1.37	34.8	1-1/4
	1/4" Face Seal Male	□-70-510-4VM-□	2.00	50.8	
	1/4" NPT Female	□-70-510-4NF-□	2.00	50.8	
540	Blank Plug	□-50-540-□	1.12	28.4	1
	1/4" Face Seal Male	□-70-540-4VM-□	1.87	47.5	
	1/4" NPT Female	□-70-540-4NF-□	1.25	31.8	
580	Blank Cap	□-60-580-□	1.37	34.8	1-1/4
	1/4" Face Seal Male	□-70-580-4VM-□	2.00	50.8	
	1/4" NPT Female	□-70-580-4NF-□	2.00	50.8	
590	Blank Cap	□-60-590-□	1.37	34.8	1-1/4
	1/4" Face Seal Male	□-70-590-4VM-□	2.00	50.8	
	1/4" NPT Female	□-70-590-4NF-□	2.00	50.8	
660	Blank Plug	□-50-660-□	0.88	22.4	1-1/8
	1/4" Face Seal Male	□-70-660-4VM-□	1.50	38.1	
	1/4" NPT Female	□-70-660-4NF-□	1.25	31.8	
670	Blank Plug	□-50-670-□	0.88	22.4	1-1/8
	1/4" Face Seal Male	□-70-670-4VM-□	1.50	38.1	
	1/4" NPT Female	□-70-670-4NF-□	1.25	31.8	
678	Blank Plug	□-50-678-□	1.00	25.4	1-1/8
	1/4" Face Seal Male	□-70-678-4VM-□	1.50	38.1	
	1/4" NPT Female	□-70-678-4NF-□	1.38	35.1	
679	Blank Plug	□-50-679-□	0.88	22.4	1-1/8
	1/4" Face Seal Male	□-70-679-4VM-□	1.75	44.5	
	1/4" NPT Female	□-70-679-4NF-□	1.25	31.8	

CGA SERIES

CYLINDER VALVE OUTLET PLUGS OR CAPS (CHAIN, RING AND POLYETHYLENE DISC INCLUDED)

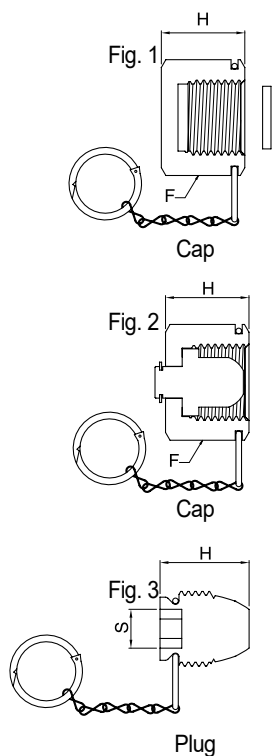

CGA Number	Ref. DWG	Assembly Part Number	H Overall Length		F Hex Flat	S Hex Flat	Washer Material
			in	mm			
320	Fig. 1	□-90-320-PD-□	.54	13.7	1	-	Polyethylene disc
326	Fig. 1	□-90-326-PD-□	.54	13.7	1	-	Polyethylene disc
330	Fig. 1	□-90-330-PD-□	.54	13.7	1	-	Polyethylene disc
346	Fig. 1	□-90-346-PD-□	.54	13.7	1	-	Polyethylene disc
350	Fig. 2	□-90-350-□	.82	20.8	1-1/8	-	-
510	Fig. 3	□-80-510-□	1	25.4	-	3/8	-
580	Fig. 3	□-80-580-□	1	25.4	-	3/8	-
590	Fig. 3	□-80-590-□	1	25.4	-	3/8	-
660	Fig. 1	□-90-660-PD-□	.54	13.7	1-1/4	-	Polyethylene disc
670	Fig. 1	□-90-670-PD-□	.54	13.7	1-1/4	-	Polyethylene disc
678	Fig. 1	□-90-678-PD-□	.54	13.7	1-1/4	-	Polyethylene disc
679	Fig. 1	□-90-679-PD-□	.54	13.7	1-1/4	-	Polyethylene disc

COMPLETE PIGTAIL CONNECTIONS (NIPPLE, NUT, WASHER AND BLANK PLUG OR CAP INCLUDED)

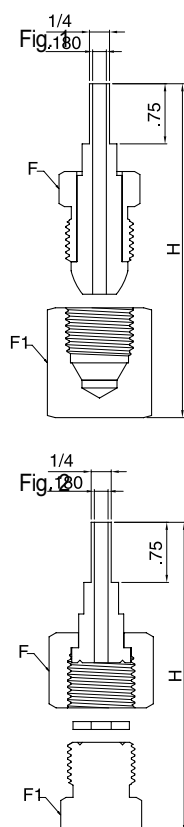

CGA Number	Ref. DWG	Assembly Part Number	H Overall Length		F Hex Flat	F ₁ Hex Flat	Washer Part Number (PCTFE)	Washer Part Number (PTFE)	Seal Enhancers Part Number (Nickel)
			in	mm					
296	Fig. 1	□-100-296-4TW-□	3.03	77	7/8	1-1/8	-	-	-
320	Fig. 2	□-100-320-4TW-□-□	2.96	75.2	1-1/8	1	PC-30-320	T-30-320	-
326	Fig. 1	□-100-326-4TW-□	3.01	76.5	1-1/8	1	-	-	-
330	Fig. 2	□-100-330-4TW-□-□	2.96	75.2	1-1/8	1	PC-30-330	T-30-330	-
346	Fig. 1	□-100-346-4TW-□	2.97	75.4	1-1/8	1	-	-	-
350	Fig. 1	□-100-350-4TW-□	2.96	75.2	1-1/8	1	-	-	-
510	Fig. 1	□-100-510-4TW-□	3.03	77	1-1/8	1-1/4	-	-	-
540	Fig. 1	□-100-540-4TW-□	2.96	75.2	1-1/8	1	-	-	-
580	Fig. 1	□-100-580-4TW-□	3.03	77	1-1/8	1-1/4	-	-	-
590	Fig. 1	□-100-590-4TW-□	3.03	77	1-1/8	1-1/4	-	-	-
660	Fig. 2	□-100-660-4TW-□-□	2.96	75.2	1-1/4	1-1/8	PC-30-660	T-30-660	-
670	Fig. 2	□-100-670-4TW-□-□	2.96	75.2	1-1/4	1-1/8	PC-30-670	T-30-670	-
678	Fig. 2	□-100-678-4TW-□-□	3.08	78.2	1-1/4	1-1/8	PC-30-678	T-30-678	-
679	Fig. 2	□-100-679-4TW-□-□	2.96	75.2	1-1/4	1-1/8	PC-30-679	T-30-679	-

DIN SERIES

COMPLETE PIGTAIL CONNECTIONS (NIPPLE, NUT , WASHER AND BLANK PLUG INCLUDED)

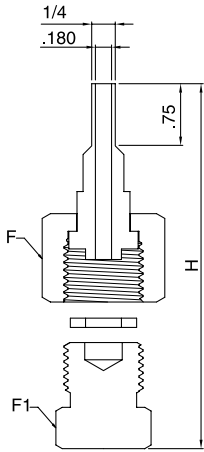

CGA Number	Assembly Part Number	H Overall Length		F Hex Flat	F ₁ Hex Flat	Washer Part Number (PTFE)
		in	mm			
1	□-100-DIN1-4TW-T-□	2.96	75.2	1-1/4	1-1/4	T-30-DIN1
5	□-100-DIN5-4TW-T-□	3.09	78.5	1-1/4	1-1/4	T-30-DIN5
6	□-100-DIN6-4TW-T-□	2.96	75.2	1-1/4	1-1/4	T-30-DIN6
8	□-100-DIN8-4TW-T-□	3.09	78.5	1-1/4	1-1/4	T-30-DIN8
11	□-100-DIN11-4TW-T-□	2.88	73.2	7/8	11/16	T-30-DIN11
14	□-100-DIN14-4TW-T-□	2.88	73.2	1-1/16	7/8	T-30-DIN14

JIS SERIES

COMPLETE PIGTAIL CONNECTIONS (NIPPLE, NUT , WASHER AND BLANK PLUG INCLUDED)

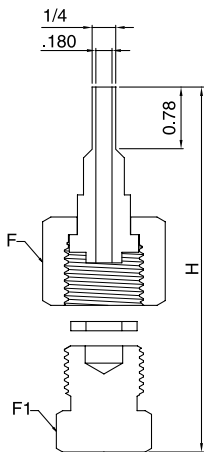

JIS Number	Assembly Part Number	H Overall Length		F Hex Flat	F ₁ Hex Flat	Washer Part Number (PCTFE)
		in	mm			
22R	□-100-JIS22R-4TW-PC-□	3.25	82.6	1-1/4	1-1/4	PC-30-JIS22
22L	□-100-JIS22L-4TW-PC-□	3.25	82.6	1-1/4	1-1/4	PC-30-JIS22
26R	□-100-JIS26R-4TW-PC-□	3.14	79.8	1-1/4	1-1/4	PC-30-JIS26
26L	□-100-JIS26L-4TW-PC-□	3.14	79.8	1-1/4	1-1/4	PC-30-JIS26

GAS CONNECTION ASSIGNMENT TABLE

GAS	CGA DISS	CGA	DIN	JIS
Ammonia	720	705	DIN 6	22-R
Argon	718	580	DIN 6	22-R or 23-R
Arsenic Pentafluoride	642	-	-	-
Arsine	632	350	-	22-L
Boron Trichloride	634	660	DIN 8	-
Boron Trifluoride	642	330	DIN 8	22-L
Carbon Dioxide	716	320	DIN 6	-
Carbon Monoxide	724	350	DIN 5	22-L
Chlorine	728	-	DIN 8	26-R
Diborane	632	350	-	22-L
Dichlorosilane	636	678	DIN 5	-
Diethylzinc	726	510	-	-
Diethyltelluride	726	-	-	-
Dimethylzinc	726	-	-	-
Disilane	632	-	-	-
Germane	632	350 or 660	-	-
Halocarbon 11	716	660	-	-
Halocarbon 12	716	660	DIN 6	-
Halocarbon 13	716	660	DIN 6	-
Halocarbon 14	716	320 or 580	DIN 6	-
Halocarbon 23	716	660	DIN 6	-
Halocarbon 115	716	660	DIN 6	-
Halocarbon 116	716	660	-	-
Helium	718	580	DIN 6	22-R or 23-R
Hydrogen	724	350	DIN 1	22-L
Hydrogen Bromide	634	330	DIN 8	26-R
Hydrogen Chloride	634	330	DIN 8	26-R
Hydrogen Fluoride	638	660 or 670	-	26-R
Hydrogen Sulfide	722	330	DIN 5	-
Krypton	718	580	DIN 6	22-R or 23-R
Neon	718	580	DIN 6	22-R or 23-R
Nitrogen	718	580	DIN 10	22-R or 23-R
Nitrogen Trifluoride	640	330 or 670	DIN 8	-
Nitrous Oxide	712	326	DIN 8	-
Oxygen	714	540	DIN 9	22-R or 23-R
Perfluoropropane	716	660	-	-
Phosphine	632	350 or 660	DIN 1	-
Phosphorus Pentafluoride	642	330 or 660	-	-
Silane	632	350	-	-
Silicon Tetrachloride	636	-	-	-
Silicon Tetrafluoride	642	330	-	22-L
Sulphur Hexafluoride	716	590	DIN 6	26-R
Trichlorosilane	636	-	-	-
Triethylaluminum	726	510	-	-
Tungsten Hexafluoride	638	670	DIN 8	-
Xenon	718	580	DIN 6	22-R

* Gas Connection Assignment Table Sources

- Compressed Gas Association Publication V-1 (2005 Edition)
- Deutscher Institute für Normung 477 Part 1 (May 1990 Edition)
- Japanese Industrial Standard B8244 (Translated) (1989 Edition)
- Japanese Industrial Standard B8246 (Translated) (1989 Edition)
- International Organization for Standardization ISO/DIS 407 (1983 Edition)
- Deutscher Institute für Normung 477 Part 8 (1990 Edition)



 **TK-FUJIKIN CORPORATION**
 *Fujikin Carp Group*

Head Office

7, Noksansandan 261-ro 88beon-gil, Gangseo-gu, Busan, Korea

2nd Factory

32, Hwajeonsandan 3-ro, Gangseo-gu, Busan, Korea

TEL. 82-51-970-6700 FAX. 82-51-831-1215

www.tk-fujikin.com E-mail : tc@tk-fujikin.com